

# The Village

## Myddle Church



The back of the church in 2008

## Myddle Church

Myddle Church is a plain substantial structure in the Western extremity of the Lichfield Diocese and the whole seems to have been of Saxon foundation. It is a building of stone in decorated style consisting of a chancel with a vestry, an organ chamber on the south side, a nave of four bays, a south aisle, north porch and a west embattled tower.

<sup>1</sup>“The upper windows are of two lights without cusps or tracery and with a shallow dripstone. The other openings are plain slits, except the lower west window which is modern. At each west corner of the tower is a diagonal buttress of six stages. The battlement is of perpendicular type being moulded vertically as well as horizontally. There are several masons marks on the north wall and a modern pointed doorway. The tower arch is pointed and plain. High up in the south west of the tower is a depressed arch, a doorway which may have been a means of access to the aisle roof. The lower part of this wall is much thicker than the rest and the stonework looks older. It is probable that it is a survival of the medieval tower. The windows are filled with decorated tracery and the arches and columns are ‘Norman’. The north doorway and porch are modern.”

## The Early History of the Church

The pre-existence of this church is implied by the mention of a priest in the Domesday entry relating to the manor. It was given primarily before the Conquerors survey by Warin the Bold (who died in 1086) to Shrewsbury Abbey and it was confirmed by the Lords Strange, the Norman Kings and the Prelates and the Bishop of Lichfield. Myddle Church was never appropriated by the monks of Shrewsbury.

In 1291 it was valued at the large sum of £20.10.00 per annum and out of this the monks of Shrewsbury took a pension of ten shillings. In 1341 the church tax was quoted as £20. The assessors however only taxed “the ninth of Parish which was £8 because the glebe and small tithes which went to form the taxation were not computable in estimating a ninth of the wheat, wool and lambs”<sup>2</sup> (five carcuates of land lay untitled and there had been a murrain among the sheep).

## The Church in Tudor times

<sup>3</sup>A valor of 1535 showed that the income of Thomas Tonge, Rector, was £16 out of which he had to pay £2 to the Chaplain of Hadnall, a pension of 13s 4d to Shrewsbury Abbey and 19s 6d for yearly Procurations and Synodals.

The Abbot and Convent presented until the dissolution of the Abbey. In 1551 their assigns presented and in 1563 the Bishop. The advowson passed the Chambres of Petton and Arthur Chambres sold it to Sir Thomas Egerton and it came to his descendents, the Earls and Dukes of Bridgewater. It is difficult to account for the diminishing value of the Rectory but the Chapels of Ruyton and Petton becoming independent churches may be the partial reason.

Nothing appears to have been handed down either in writing or tradition of the time when or by whom the Church of Myddle was originally built. The lower storey of the tower on the side is Norman walling.



## The Church steeple in 2008

The steeple was at first built of stone as high as the wallplate of the church, and upwards it was built of timber.

---

2 Rev. RW Eyton “Antiquities of Shropshire” Vol10  
3 Bridgewater Collection Box of Middle Manor

## The Seventeenth Century

In the time of Mr. Ralph Kinaston (also Chaplain to James I) 1596-1629 Rector, the tower was ruinous and he wanted the parishioners to take it down and rebuild it, and offered to pay himself for the ground work and would build to his own height and put a stone there to show how high he had built at his own charge. The parishioners would not agree. Mr Kinaston died and soon after the steeple fell and the parishioners were forced to rebuild it.<sup>4</sup> The new tower was erected in 1634 and the mason was John Dod who lived at Clive and his wages were £5 for every yard from the bottom of the foundation to the top of the battlements. John Dod must have had other masons to help him because of the number and variety of masons' marks on the stones. These were put on the stones for the purpose of distinguishing each man's work so that in the case of defective or faulty workmanship the overseer could at once know by whom it was done and by whom it ought to be rectified, and in the case of piecework, so that the artisan produced work which when examined and passed by the overseer could receive the remuneration due to him for his labour. (see fig 15)

<sup>5</sup>In 1651 two masons and a boy were paid 5s 4d for mending the steeple and a further £1 was paid for a new weather cock. In 1656 Henry Maddox was paid 12s 8d for covering the porch and making a door cresting in the church. In 1658 6d was paid for repairs to the church yard gate but this was replaced by a new one in 1662 (See appendix 14). The rector at this time, Reverend Wilton, wrote out an account of the order and manner of repairing the churchyard fence. In 1667 11d was paid for an item of timber to mend the Lichgate. The Lichgate was the shed at the entrance to the churchyard, where the corpse rested until the minister arrived. In 1678 a Book of Common Prayer was purchased for 13 shillings. (see Appendix 15 for a "Plan of the Church as it was Anciently)

During the Civil Wars the communion table was placed in the middle with the benches around it for the communicants to sit upon. At the Restoration of Charles II a new table was brought and the benches were removed and the table and rails restored to their former situation.

Fig 15

---

<sup>4</sup> SAS Volume 7, 2<sup>nd</sup> Series (1895) p viii

<sup>5</sup> Church Wardens Accounts, Myddle Box, CRO



Myddle Church looking N Taken 1965



Myddle Church looking N Taken 1930's



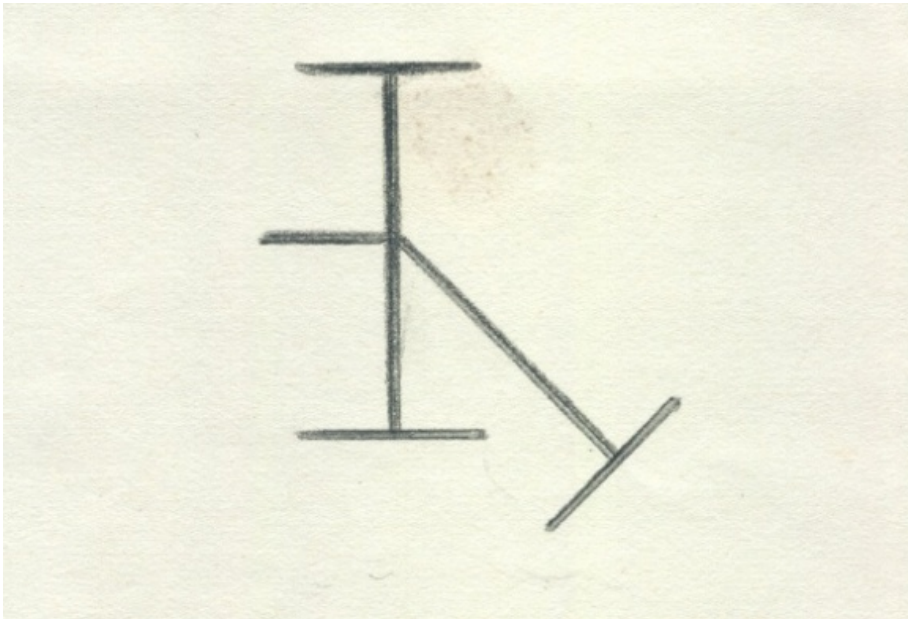

Examples of masons' marks to be found in Myddle Church

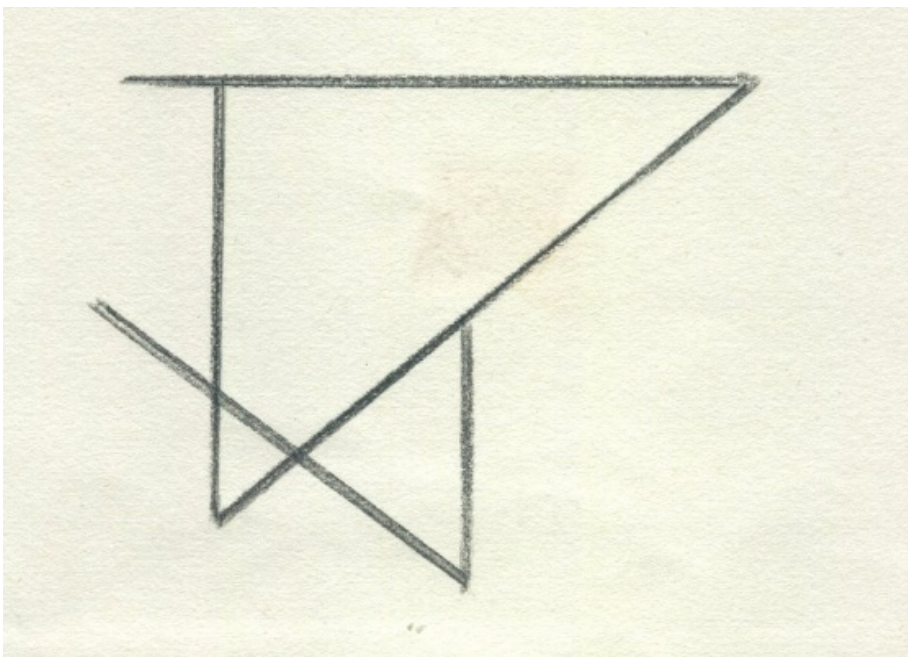

## The Eighteenth Century

(see Appendix 16 for the seating plan of 1701).

The body of the church was rebuilt in 1744. <sup>6</sup>£1120 was asked for in a brief issued in 1742-3 but only £164.18.9d was received. The rebuilding cost £255. On a tablet on the east wall of the porch is the following inscription "This church was rebuilt in A.D. 1744" Edward Hanmer, John Bate, Thomas Shaw, Churchwardens. Henry Jenks, Richard Atcherley jun., Edward Hanmer, Richard Wall and Richard Groom were trustees. Who were the architects and builders and how long a time elapsed before it was completed is not known. After the rebuilding of the church, the reallocation of seats was needed. A pew belonged to a house, so if a man moved from one house to another he did not have the same seat; this belonged to the first house. (See Appendix 17 for the seating plan of 1744). The royal arms of 1775 are found over the tower arch.

## The Nineteenth Century

In 1810 it was found necessary to make a new seating plan. (See Appendix 18)

We learn from the vestry book that in 1821 a meeting was held to consider the propriety of erecting a new gallery. It was decided to do so and that a subscription should be raised for the purpose. The work, however, does not appear to have been then carried out, for in 1822 the Archdeacon, Hugh Owen, directed a forcible charge to the Ministry and Church Wardens of the different churches in his Deaconry. He made a tour to inspect them. In consequence at Myddle, the Rev. George Burd and Mr Pickstock one of the church wardens entered into a consultation respecting the repairs of the interior and employing an architect who upon investigation pronounced the gallery to be in a very dangerous condition. Consequently, a sum of £45.9.1d was spent in repairing it and in re-colouring the interior of the church. In 1823 the Archdeacon again inspected the church and this time was perfectly satisfied. At a Vestry Meeting held on 8<sup>th</sup> September 1826 it was decided that an entirely new free gallery and vestry should be erected. A contract was entered into with Mr. Thomas Millington who agreed to complete the works for the sum of £160. The greater part of this sum - £140 - was raised by private subscriptions and the remaining £20 by a rate of 2d in the pound.

No further change of material consequence took place till the year 1848. A considerable alteration was then carried out in the Chancel. The windows were entirely renewed, decorated tracery being inserted in both and stained glass placed in the east window as a memorial to the late Rector, The Rev. Thomas Egerton. (See fig 16)

The window bears the following inscription: "This window is erected by Charlotte C. Egerton in affectionate memory of her husband, the Rev. Thomas Egerton, who was the faithful Minister of the Parish of Middle for 3 years, when it pleased God to remove him from his earthly labours, September 17<sup>th</sup> 1847, aged 37."

The exterior appearance of the chancel was also improved at the same time by the erection of stone buttresses and a handsome stone coping terminating in a cross on the gable. The

---

<sup>6</sup> Rev. DHS Cranage "An Architectural Account of the Churches of Shropshire" p163

whole expense of this alteration was defrayed by Mrs. Thomas Egerton. Another seating plan was made in 1855 (See Appendix 19).

<sup>7</sup>At a vestry meeting held on the 6<sup>th</sup> March 1856 it was unanimously agreed to take down the present pews and sitting places on the ground floor of the church, together with the pulpit and reading desk and to re-erect them nearer to the altar, to remove the font into the tower, to take down the east and west wing of the present gallery, to re-roof the entire church and to rebuild the vestry with a porch near it, and that the plans of Mr. Cunningham, Architect, should be adopted and the expense should be defrayed chiefly by voluntary contributions assisted by a rate upon the inhabitants of the parish. These alterations called for another seating plan which was made in 1858 and this shows the new sites of the font and pulpit. (See Appendix 20). Some seats were to be set apart and these were to be marked free so that the poor people of the parish could use them. How much the alterations cost, or how long they took before they were completed is not know. At a vestry meeting of 1871 it was decided that necessary repairs should be made to the ceiling and these were subsequently carried out. In 1874 Messrs. Whiteley of Chester were hired to clean and repair the organ. Two new stops were put in, a new set of pedals and a new set of keys., the bellows were increased in size, the old pipes were revoiced and then the whole was enclosed in a Swell Box. All this cost £40. In 1877 the chancel was restored and the organ chamber built.

#### The Twentieth Century to the present day

No other major alteration has been undertaken. In recent years it has been necessary to point the building and put new cement between some of the stones, but this is all. At different times the church has been decorated. The oil lamps (see fig 16) were taken out and electricity was installed in the early 1950s.

#### Myddle Church Organ

Myddle church organ has unusual features . It was built by the very eminent firm of Hill and Son but the date is not given on the name plate. <sup>8</sup>The tone is not outstandingly good but it does possess a proper family of foundation stops pitched in accordance with the natural harmonies of nature. The curiosity, however, lies in the colour of the keys and the designations of the stops. The keys are black for the naturals and white for the sharps. The modern way round, which is the reverse, seems to have come in in the eighteenth century, though the old did persist in the nineteenth. It seems a pointless eccentricity at Myddle, especially in conjunction with the stop designations <sup>9</sup>“These are in what can least unkindly be described as invented Latin, e.g. ‘Regula Primana’ and ‘Tibia Pileata Gravis’ for the ‘Diapason’ and ‘Bourdon’ of very long-standing sanctions and the conventional pitch figures, e.g. 16 foot, are given in Roman numerals – except that the correct 2<sup>2</sup>/<sub>3</sub> foot for the Twelfth must have been too awkward and appears as III” R.G. Moseley.

---

<sup>7</sup> Vestry Minutes Book, Parish Chest

<sup>8</sup> R.J. Moseley “Myddle Organ” Shropshire Magazine 1954

<sup>9</sup> R.J. Moseley “Shropshire Organs” Shropshire Magazine 1955





Fig 16

Photograph showing the interior of Myddle Church with oil lamps. The original is on display in the church.

Fig 17

Myddle Church Organ



It is probable that the famous Victorian musical antiquarian W.S. Rockstro (1823 – 95) may have had something to do with it as he did the same thing at St. John's Torquay, 1872 and at All Saints' Babbacombe, where he was organist in 1873, and at other churches thereabouts. Hill, the organ builder, frequently used Latin stop names and Mr Edwards, a past president of the Organ Club thought that the famous hymn writer, Dr Gauntlett, who was born in the town of Wellington may have originated the idea.

### The Church Windows

There are stained glass windows dedicated to various people who lived in the parish. One is to William Parry, 1871. The work in the glass was by Messrs. Shaw of Saddleworth near Manchester and cost £20.

### The Lych Gate

The oak lych-gate with figures of Christ and Peter in the gable ends was erected in 1898 to commemorate the jubilee of Rev. G. H. Egerton as rector.

### The Font

Under the tower is a modern carved octagonal font (c1931). G. H. Egerton carved the front cover in olive wood brought from the Holy Land.

There is an ancient oak chest with three locks which stands at the west end of the baptistery. It was in existence before 1700 as it appears on Gough's plans "As the church was anciently," but not on the "Church as it is now 1701."

### The Church Bier

Another possession of Myddle Church is an old bier. This was used to move the coffin up the aisle of the church but now the undertakers have their own newer and lighter version.

### The Ducking Stool

Over the vestry door is the chair part of the old ducking stool which was used to put witches on and then duck them in the pool at Marton.

### The Church Silver (not now on display)

The communion plate is a silver salver given by Mrs. Elizabeth Vaughan, the daughter of Mr. John Downton of Alerton to the Parish Church of Myddle in the 74<sup>th</sup> year of her age, 1744. The chalice is dated 1729 and inscribed Middle Exchang'd 1730, Tho. Bickerton, John Crump. A paten is dated 1891 and inscribed "In Dei gloriam de d. EAO 1891" . A flagon is dated 1845 and inscribed "From Thomas Egerton, Rector to the Church of St. Peter's, Middle".

### Chained books (not now on display)

Three old chained books still remain in the Church though the chains are now gone except for one link attached to the spine of the book. They are a Paraphrase of Erasmus in black letter dated 1522, Jewels Apology 1560 and Whitgifts Defence 1574. They are in fairly good condition and are kept in a modern showcase just to the right as one enters the church.

## The Church Bells

The first mention of bells in Myddle Church are in the Church Warden's Accounts. In 1652 Richard Clark was paid 14 shillings for stocking the three bells. Later in the same year he was paid a further 2s 6d for mending the brass of the little bell. In 1659 one of the bells again had to be mended and in 1660 Allen Challenor was paid 1 shilling for iron work about the bell. In 1663 about £5 was spent on repairing the bells. In 1668 5s 4d was paid to the bell founders who came to tune the bell. One must not have been very good as later in the year £12 was paid for casting the bell, a further £4.10.0d for the over metal and 6 shillings which the bell founders charged for hanging the bells. The bell founder claimed 8 shillings for dinner for his wife and servants and 12s 6d for ale, both of which were the custom. The tenor bell is by Thomas Clibury and has a good original inscription printed in the usual small thick letters. This bell stands 35 inches high. The inscription reads "Caeteros voco ipse non intro" Rich Goughe Will Formaston CW. 1668. The inscription means "I summon others but enter not myself." This bell is interesting for another reason, the Richard Gough mentioned was a local historian and author of "The History of Myddle".

<sup>10</sup>The treble bell is by Abraham Rudhall and has the inscription "Mr Edward Hanmer; Mr Adam Downes, churchwardens 1715." This bell is 30 inches high and the lettering is done in fine print. <sup>11</sup>The second bell has in Gothic lettering "Petrus Apostolus et Paullus Doctor Tenorum" which is a unique and original inscription. This bell is 32¾ inches high. At the beginning of this century it was found necessary to replace the framework and to rehang the three bells at the cost of £35.0.0. The bells were sound but deeply indented where the clappers had struck them over the years.

---

<sup>10</sup> Rev. Hartstone "Salopia Antiqua" p.590

<sup>11</sup> SAS Volume 1, 4<sup>th</sup> series, P.33

Fig 18



The Lych Gate



The Font



The Oak Chest



The bier as photographed around 1966

Figures 19 and 20



The chained books

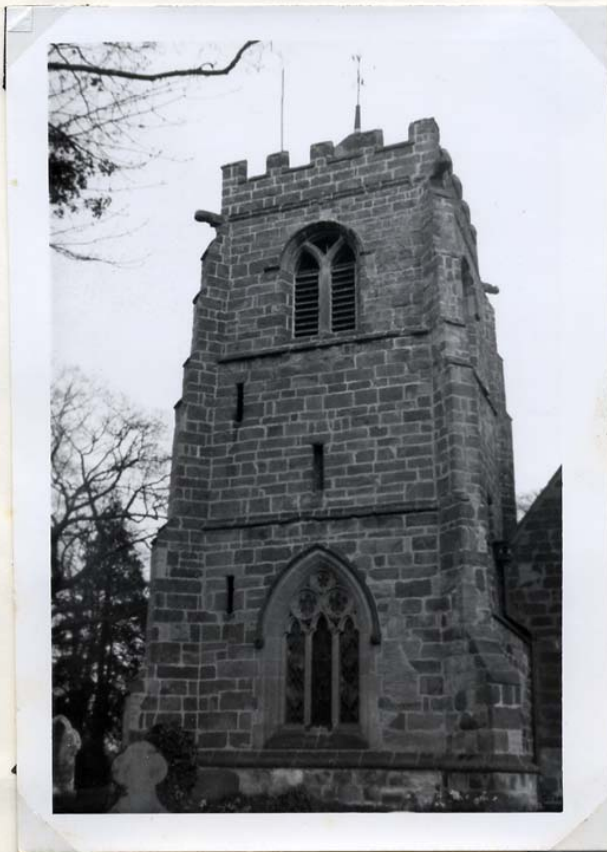

The Church Tower

### Parish Registers

The parish registers are very old, the first entry being December 1541, which is within three years of their introduction. The first which is wholly in Latin, from the beginning to year 1599 is a copy of an earlier Register and each page is signed by Ralph Kinaston rector, and Houmfrey Reanaldes and Richard Goughe, churchwardens. The occupations of the father and the township where they resided are usually stated. The second volume is in poor condition. Entries are in Latin up to 1637 and then in English. The third volume extends from 1681 – 1758 although one or two leaves are missing. The fourth volume contains only baptisms and burials from 1759 – 1799. The residences and occupations are not given in this volume. The fifth volume contains marriages 1754 – 1793 and the sixth volume contains baptisms 1799 – 1812. From the beginning of the nineteenth century the various entries for births, marriages and deaths in Myddle seem to have been separated into different books.

### Brasses and monuments

There are various brasses and monuments in the Church. The oldest remembers Arthur Chambre of Petton, patron of Myddle who died in 1564, his wife and two children. He wears a fur lined gown with a Tudor ruff and his wife wears an embroidered gown and a Mary Queen of Scots cap and ruff. The inscription speaks of Arthur Chambre as “trewe patron of this passhe church of Myddle.” Another is in memory of Mr. Ralph Kinaston, Rector, who made the offer of the tower building. He was also chaplain of King James and died 1629. On the north wall of the nave are monuments to the Atcherleys of Marton. On the south wall of the chancel is a brass cross in memory of a rector of fifty eight years, (Rev. G.H.Egerton) who died 1905. There are also a number of smaller brasses. The oak tablet on the south wall commemorates 135 parishioners who served in the Great War.



## St. Peter's Church, Myddle

Rectors of Myddle Parish from 1068 to 1958	
1086	A priest who was not named
1232	<b>Howell ap Griffin de Bromfeld</b> (younger son of Prince of Lower Powis)
13 <sup>th</sup> Century	<b>Master Walter</b>
1317	<b>Thomas de Charnes</b> exchanged for Kingslee 1333
1333	<b>John Watenhall</b> incumbent of Kingslee
1334	<b>Nicholas de Clebury</b> a sub deacon. On 21 <sup>st</sup> May 1334 he was given a licence of non-residence for 2 years to study
1341	<b>John Normaund</b> rector of Kingislonge
1358	<b>Henry de Suggenhull</b>
13 ?	<b>Robert de Coventre</b> died in 1360
1360	<b>John Digg</b> who was in the household of Sir Simon de Sudbury and appointed by provision of Pope Innocent VI
136?	<b>Hugh de Young</b> also rector of Willey and prebendary of St. Mary's, Shrewsbury and he exchanged for Lundusshall in 1379
1379	<b>John De Hull</b> , rector of Lundusshall and he exchanged for Old Swinford in 1387
1387	<b>Philip de la Lee</b> , rector of Old Swinford
13?	<b>Nicholas Coningston</b> who exchanged for Hathersage in 1399
1399	<b>John Berford</b> rector of Hathersage who resigned in 1404
1404	<b>William Wallenford</b> chaplain, vicar of Donnington 1404, occurs as rector of Upton Magna in 1412 when he resigned.
1412	<b>Nicholas Sylain</b> who resigned in 1422, rector of Prees 1422-38
1422	<b>William Corley</b> died 1425
1425	<b>Lawrence Rocke</b> who resigned in 1440
1440	<b>Thomas Redman</b> who resigned in 1441
1441	<b>David Kennesbury</b> who resigned in 1446, alias A berry n priest
1446	<b>John Newton</b> Canon or prebendary of St Chads, died 1451
1451-2	<b>William Lock</b> chaplain, who died in 1488
14 ?	<b>Nicholas de Clebury</b>
1488	<b>Richard Arderne</b> priest who died in 1511
1511	<b>Thomas Tonge</b> named as rector in the "Valor" of 1535
1551	<b>John Higgins</b>
1563	<b>Richard Foster</b>
1568	<b>Thomas Wilton</b> who died in 1596. He wrote an account of the order and manner of repairing the church yard fence
1596	<b>Ralph Kinaston</b> – "a good hospitable and very charitable man" Richard Gough
1629	<b>Thomas More</b> . He was the first rector that was presented by the Earl of Bridgewater. More was a Yorkshireman, vicar of Ellesmere where he lived and he came once a month to a service. At other times a curate took his place. He was displaced by parliament during the Civil War, and Joshua Richardson substituted. On the death of Mr More, Richardson was allowed to continue as rector, but on the restoration of Charles II he refused to subscribe the Declaration inserted in the Act of Conformity concerning the solemn league and covenant, and so he was displaced.
c1646	<b>Joshua Richardson</b> who was vicar of Holy Cross 1645-7. "He word a dagger at his girdle under his upper garment even when preaching" said Gough. In his will he left Bibles to certain poor people of the parish.
1662	<b>William Holloway</b> MA who died 1689
1689	<b>Hugh Dale</b> who resigned in 1720

1720	<b>Hon. Henry Egerton</b> who was also Rector of Whitchurch in 1720. He was Bishop of Hereford in 1724.
1746	<b>Egerton Leigh</b> Archdeacon of Salop 1741 – 1760. He resigned from Myddle in 1749.
1749-58	<b>Peter Leigh</b> , also rector of Lymme, son of Egerton Leigh. He died 1758.
1759	<b>John Leigh</b> who resigned in 1759
1759	<b>Robert Reynolds</b> who died in 1767
1767	<b>Richard Smyth</b> who died in 1797
1797	<b>Francis Henry Egerton</b> , rector of Whitchurch in 1781. He died in 1829
1829	<b>James Horsman</b> who was incumbent at Hadnall 1836-40. He died in 1844
1844	<b>Thomas Egerton</b> who died in 1847
1847	<b>George Henry Egerton</b> who was Prebendary of Lichfield 1862. He died in 1905.
1905	<b>Eric John Williams Nesbitt</b> who resigned in 1937
1937	<b>Edgar Burford</b> who died in 1952
1953	<b>Vincent Gower Jones</b> who resigned in 1958
1958	<b>John Ayling</b>
Rectors of Myddle Parish from the end of the project to the present day	
1970	<b>Frederick Chapman</b>
1971	<b>David Samuel Evans</b>
1980	<b>Charles Philip Collis-Smith</b>
1992	<b>Elizabeth Ann Hadley</b>
2000	<b>David Trevor William Price</b>
2008	<b>Peter Barnes</b>

#### **Appendix 14 - Myddle Churchyard Fence**

The Rev. Thomas Wilton appears to have been the first rector of Myddle after the Reformation. He is said to have written out an account of the order and manner of repairing the churchyard fence but the original being lost, a copy was taken by Mr. Randle Cook which is as follows.

The churchyard rail begins at the east end. The Woodhouses belonging to Myddle repair 6 yards. (The Woodhouses or Woodlands are tenements in Brandwood-Fewterell, Bickley's Wills, Noneley's, Guests, Hordleys, Taylors and Chidloes). These are to repair 6 yards over against Mr Gittens house.

Next along the south side Myddle repairs 18 yards. Next along the south side Webscott repairs 18 yards. Next Marton repairs 8 yards. Next Sleaf Hall repairs 7 yards which ends at the S.W. corner and the water course which runs through the churchyard runs under Sleaf Hall rails.

From the corner along the west side Hadnall repairs 39 yards, next Alderton repairs 7 yards over them is a step into Eatons yard. Next Newton repairs 10 yards, next Houlston repairs 8 yards which ends at the west corner of Myddle Street. Next Balderton repairs 7 yards; the water course runs under these rails where the wall begins.

Next Marton repairs 18 yards and a stile, next Myddle repairs 18 yards, Next Sleaf Hall repairs 5 yards, next Houlston repairs 5 yards, next Newton repairs 8 yards and two stiles, next Hadnall Ease repairs 40 yards, next Webscott repairs 5 yards, next Alderton repairs 9 yards, next Balderton repairs 9 yards which ends where the rails begin.

The other stile belonging to Newton is at the Litch Gates. Newton 8 yards in the wall end at the corner by the stocks (which have now disappeared 1966), that corner of the wall is to be repaired by Newton and Hadnall Ease equally. Webscott's 5 yards lies 3 on the north side of the Litch Gates and 2 on the south side and Newton makes the stile over the 2 yards.

n.b. these yards are something larger than the standard.

Taken from the original document 1661 in the Parish Chest.

# Appendix 15 – As The Church was Anciently.

Seating plan, taken from "The History of Myddle" by Richard Gough.

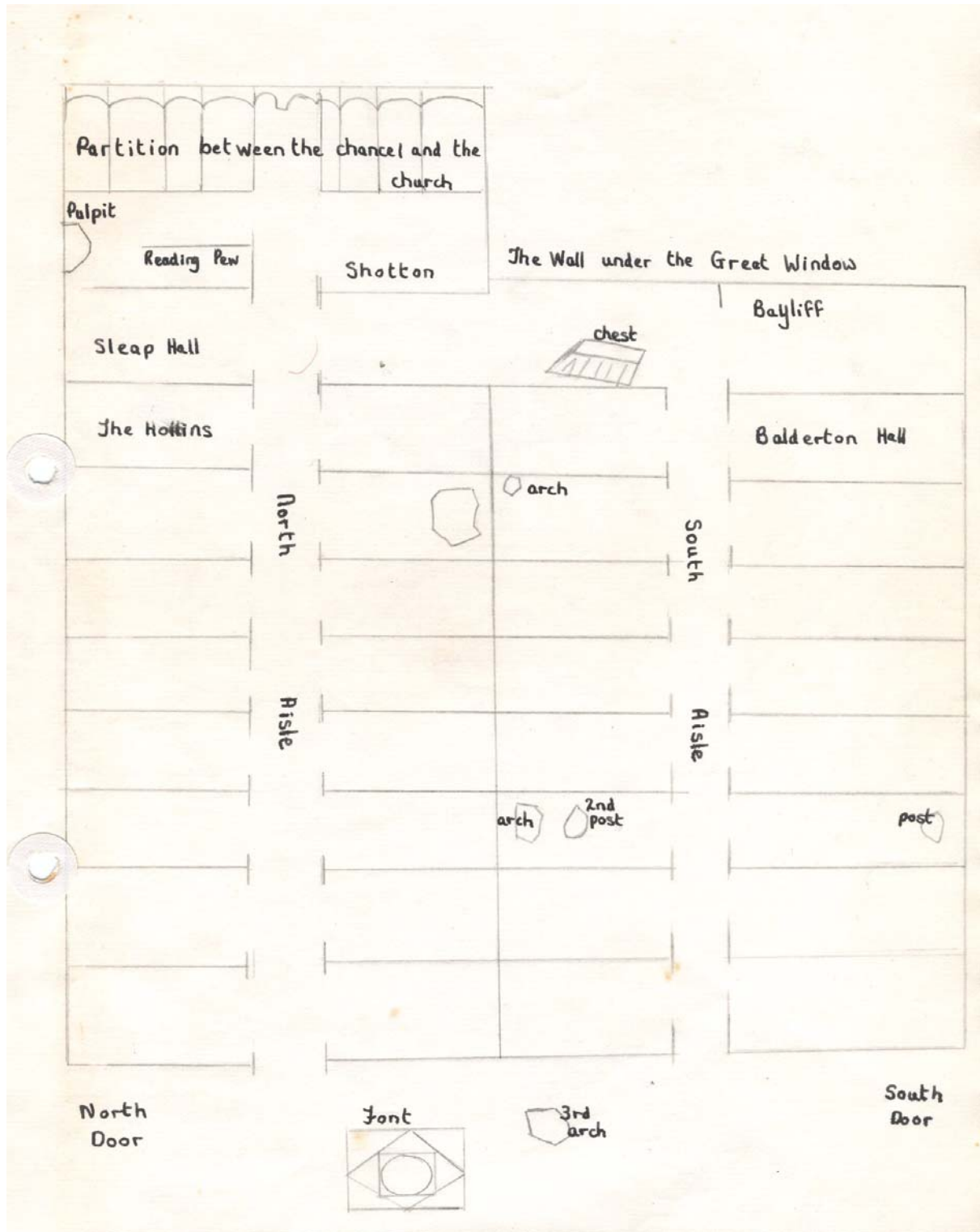

## Appendix 16 – The Church 1701

Seating plan, taken from "The History of Myddle" by Richard Gough.

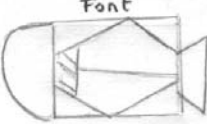
		The wall under ye Great Window			
		1 Shotton			
	Reading Pew	Thomas Moore for ye Eagle Farm	Broomhurst Farm	1	1 Mr Cotton
1	Mr Atcherley Marton Mr Hammere	3 Richard Gough Mr. Atcherley Mr. Cotton	Mr Gittins for Castle Farm	2	2 Balderton Hall
	Sleep Hall	Billmarsh Rob Hayward - Newton		3	Wright's tenent in Marton
2		4 Jho Mathers - Balderton Rich Groom	Castle Farm		3 Stephen Formstone
	The Hollins Farm	5 Shotton for Servants	Webcott Arch	4	Nightingale's tenent Taylor in Balderton
3	Sleep Hall	6 Mr Cotton Rich Gough Rich Groom 1/4 Jho Hall	Rob Hayward Mr Muckelstone Sam Brain	5	Jho Shaw in Marton James Featrell
4	Mr Hammere Mr Atcherley Marton	7 Holstone	Mr Hatchet John Eaton	6	5 Domeley's tenent Taylor's tenement
5	Mr Lloyd (house over against N door of church)	8 Jho Gittins Wid. Mansell John Horton	William Annis Wid. Bickley	7	Rich Gough Wid. Mansell
6	Edward Garland - Newton Balderton Hall for Servants	9 Rich Gough Wilson's tenent Hunt's tenent	Richard Voyd Post	8	Vicar Gittens
7	Mr Atcherley for Servants	10 Mr Hatchet's tenent in Newton Tylar in Balderton	James Featrell	9	7
8	Sam Brain John Eaton Tho Pierce	11 Mr Muckelstone Guest's tenement	Ed Garland John Hadley	10	Wm Challenor now Stephen Jonesnow Groom Post
9	The Warehouse Rich Clark Wid Russol	Highway	Ed Cooper	11	Hardley's tenants Edge's tenants Ralph's tenants Rich Atley
	North Door	12 Jho Davies	Jho Davies Wm Willet Shoemaker	12	Watson tenement Davies Cottage Baxters Cottage Chidlows Cottage
		13 Freeman of Marton	Bradch	13	Dan Hammer Wm Challenor
					Challenor late Clark
					Wm Jones Wid Groom
					South Door

# Appendix 17 – Seating Plan of 1744

Original in the Parish Chest

1	Mr Atcherley Marton Mr Hammer Sleep Hall			William Thordike for Mr - at Alderton
2	Joseph Cleaton (Duke's)			William Curston for his home
3	Joseph Cook Sleep Hall	1	Mr John Watkins For Shotton	Bartholomew Ebrey (Duke's) 1
4	Mr Atcherley Mr Hammer	2	John Bates	The Husbands (Duke's) 2
5	Mr Jeffries had been Mayo	3	A common seat	The Husbands (Duke's) 3 Robert - of Hadnal one seat
6	to Crinston Balderton Hall The Womersley for Gaudard	4	John Haynes - Marton William Curston - Balderton Joseph William - Newton Sam Richerton - Bilmarsch	John Edge for Miss Price & Webscott 4
	Pulpit	5	William Bucknell for Mr Watkins of Shotton	John Eaton William Eaton (Duke's) 5 William Curston Balderton Sam Owen Alderton
	Reading Desk	6	John Haynes - Marton The Shaw - Newton William Broughall	John Eaton 3 Thomas Price Thomas Wormalley 3 (Duke's) 6
7	Mr Atcherley Marton	7	William Rogers Robert Davies - Hobson John Galt for Mr Jeffries	Mr R. Atcherley Alderton The Wynne Brandwood 7
8	John Eaton William Eaton Thomas Price (Duke's)	8	Adam Davies Bartholomew Mell (Duke's) Richard Mordell (Duke's)	Mr Atcherley and J Wynne 8
9	The Husbands (Duke's)	9	William Broughall Ralph Guest (Duke's) R. Mell (Duke's)	Rob Davies, James Pugh Robert Starway (Duke's) 9 John Mordell
10	Adam Davies for Clerks	10	John Bates (Duke's) Will Curston Thomas Wormalley (Duke's)	Sam Surrack James Pugh (Duke's) 10
11	John Edge for Miss Price & Webscott	11	Richard Mell for Brandwood (Duke's)	A Arthur Munsley John Hewitt (Duke's) 11
12	Thomas Powis Esq. for Hardwig	12	George Watson widow Richard Bowen (Duke's)	John Davis Robert Morris (Duke's) 12
13	The Rector Mr. Leigh for Parsonage house	13	W. Atcherley for Threshold at Marton	Mr Hill for all his in Hadnal 13
14	Mr Hammer The Shaw	14	Mr Genkes for the Birches	Richard Pigstall Hoston Joseph Tolbert Hoston John Hildinge Hoston 14
	William Buddle - Webscott The Roberts - Webscott The Roberts - Hason			Thomas Brown at Hadnal Rich Mayo - Hordilton Will Eaton home at Brandwood



**Appendix 18 – Seating plan of 1810**

The Rector	The Rector		
1 Richard Atcherley Esq 3 Sleep Hall 3	1 Shotton	Lord Bridgewater 1	1 Alderton Mr Fox's Farm,
2 Lord Bridgewater			2 Balderton Hall
3 Sleep Hall	2 Lord Bridgewater	Lord Bridgewater 2	3 Lord Bridgewater
4 Richard Atcherley Esq	3 Richard Atcherley 1 Mr Fox Alderton 1 Mr Cureton Billmarsh 1	Lord Bridgewater 3	4 Samuel Stanforth
5 Lord Bridgewater	4 Lord Bridgewater	Webbscott 4	5 John Davies Newton
6 Balderton Hall	5 Shotton	Lord Bridgewater 5	6 Lord Bridge water
7 The Clerks Seat	6 Lord Bridgewater	Lord Bridge water 6	7 Rich Atcherley Esq
Pulpit and Desk	7 Mr Shingler Houlston 2 Mr Shingler Alderton 2	Mr Corbet Alderton 7	8 Richard Atcherley Esq
8 Richard Atcherley Esq	8 Mr Birch Kennemere Mr Powell Richard Atcherley	Lord Bridgewater 8	9 Lord Bridgewater
9 Lord Bridgewater	9 Mr Bickerton	Lord Bridgewater 9	10 Lord Bridgewater
10 Lord Bridge water	* 10 Lord Bridgewater Mr Bickerton	Lord Bridgewater 10	11 Lord Bridge water
11 Webbscott	11 Lord Bridgewater	Lord Bridgewater 11	12 Lord Bridgewater
12 John Hill Esq	12 Lord Bridgewater	Lord Bridge water 12	13 Lord Bridgewater
13 The Rector	13 Richard Atcherley Esq	Lord Berwick 13	* 14 John Bickerton Lord Bridgewater
14 Lord Bridge water	14 Black Birches	Seth Pickstock Heston 14	15 George Hilditch Heston
			16 Mr Farmer and Mr Davies
			17 Lord Bridgewater.

“We whose names are hereunto subscribed being the owners and proprietors of Messuages or Dwellings Lands and Hereditanments in the Parish of Middle in the County of Salop do testify our full approbation of and consent to the above arrangements and exchange in pews and sitting in Church.” 17<sup>th</sup> March 1810, Bridgewater, Richard Atcherley, Rich Bickerton, Sam Staneforth, Seth Pickstock.

\*These two pews were exchanged on 11<sup>th</sup> December 1820 by Robert Helerk Esq. And Richard Bickerton. Mr Bickerton giving N14 to and receiving N10 from Lord Bridgewater. Witness George Burd, Curate.

At the building of the Gallery the seat N1 belonging to Alderton Mr. Shingler's farm, late Mr. Fox farm was allowed by Mr Shingler to be taken for the staircase upon condition of receiving N14 in exchange

29<sup>th</sup> June 1829 George Burd, Curate



Appendix 19- Seating plan of 1855

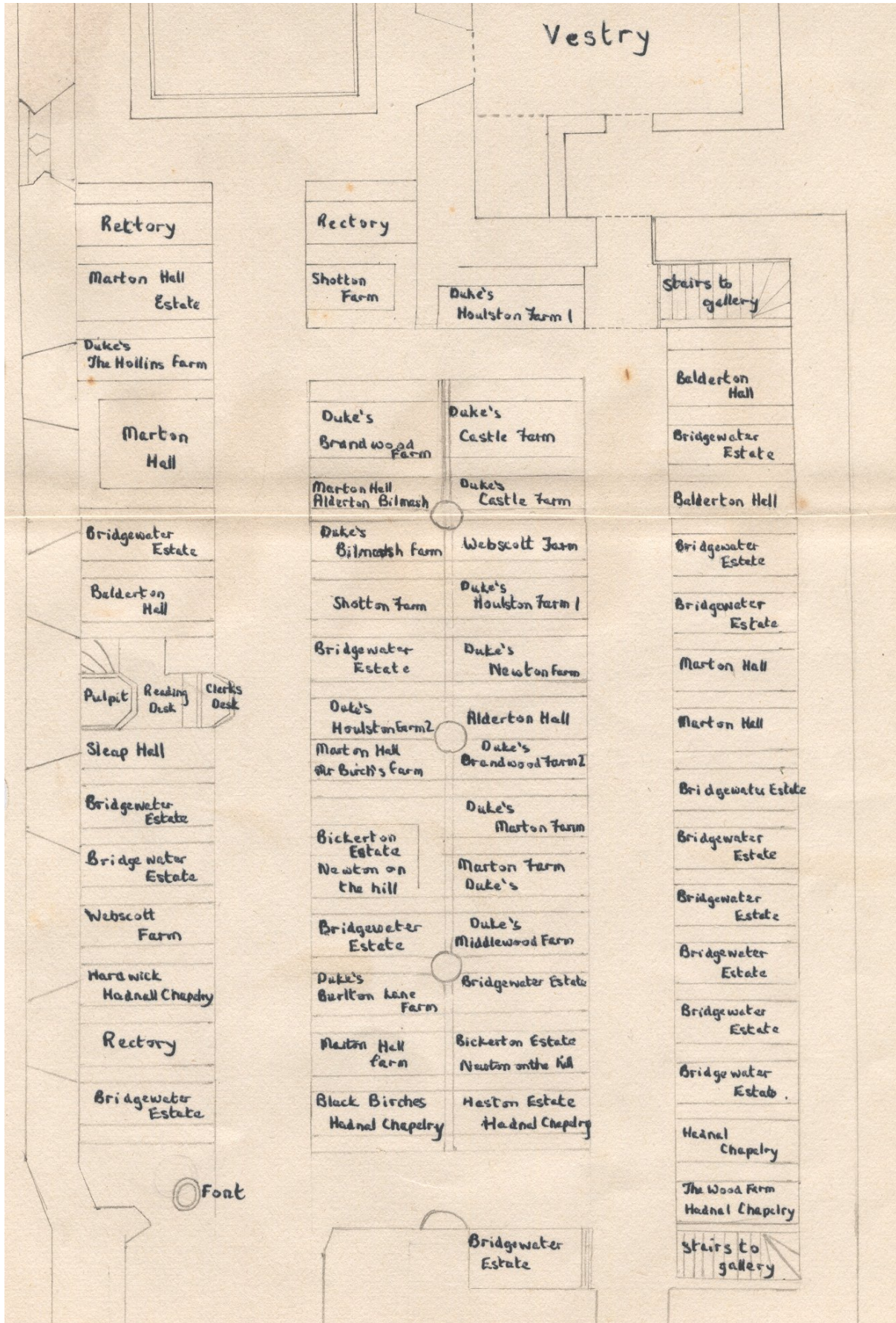



Plan of the Gallery 1855

The Gallery  
1855

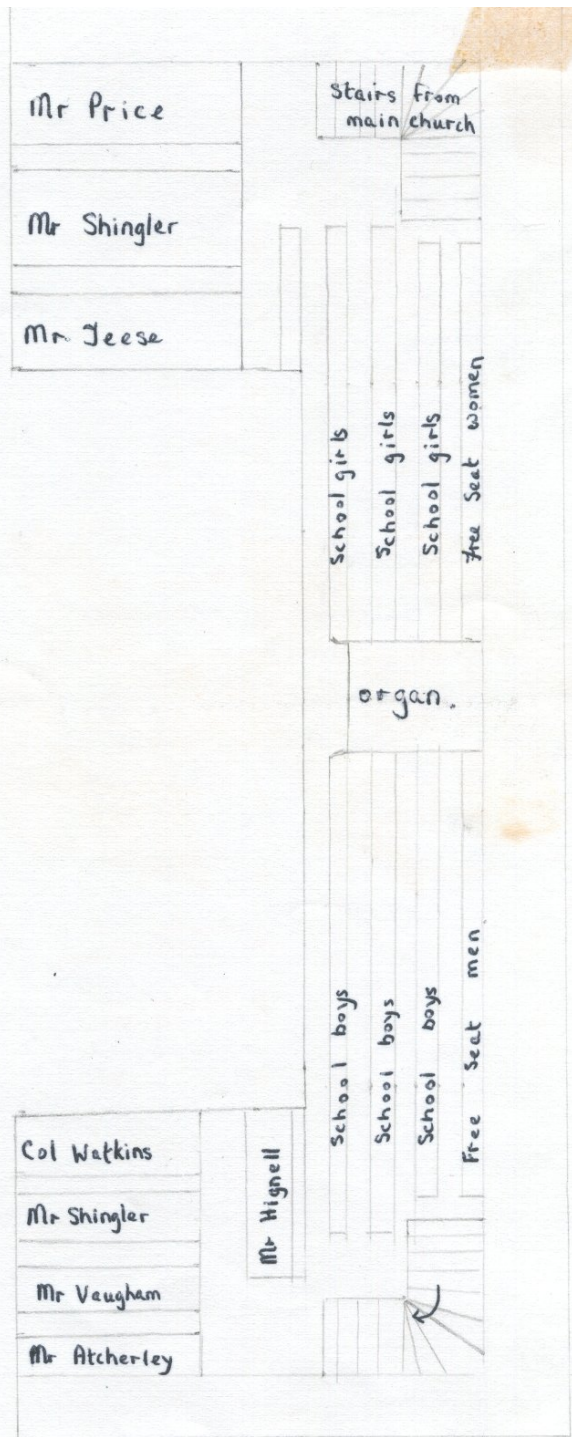

**Appendix 20 – Seating Plan 1858**

