

#### **Appendix 14 - Myddle Churchyard Fence**

The Rev. Thomas Wilton appears to have been the first rector of Myddle after the Reformation. He is said to have written out an account of the order and manner of repairing the churchyard fence but the original being lost, a copy was taken by Mr. Randle Cook which is as follows.

The churchyard rail begins at the east end. The Woodhouses belonging to Myddle repair 6 yards. (The Woodhouses or Woodlands are tenements in Brandwood-Fewterell, Bickley's Wills, Noneley's, Guests, Hordleys, Taylors and Chidloes). These are to repair 6 yards over against Mr Gittens house.

Next along the south side Myddle repairs 18 yards. Next along the south side Webscott repairs 18 yards. Next Marton repairs 8 yards. Next Sleaf Hall repairs 7 yards which ends at the S.W. corner and the water course which runs through the churchyard runs under Sleaf Hall rails.

From the corner along the west side Hadnall repairs 39 yards, next Alderton repairs 7 yards over them is a step into Eatons yard. Next Newton repairs 10 yards, next Houlston repairs 8 yards which ends at the west corner of Myddle Street. Next Balderton repairs 7 yards; the water course runs under these rails where the wall begins.

Next Marton repairs 18 yards and a stile, next Myddle repairs 18 yards, Next Sleaf Hall repairs 5 yards, next Houlston repairs 5 yards, next Newton repairs 8 yards and two stiles, next Hadnall Ease repairs 40 yards, next Webscott repairs 5 yards, next Alderton repairs 9 yards, next Balderton repairs 9 yards which ends where the rails begin.

The other stile belonging to Newton is at the Litch Gates. Newton 8 yards in the wall end at the corner by the stocks (which have now disappeared 1966), that corner of the wall is to be repaired by Newton and Hadnall Ease equally. Webscott's 5 yards lies 3 on the north side of the Litch Gates and 2 on the south side and Newton makes the stile over the 2 yards.

n.b. these yards are something larger than the standard.

Taken from the original document 1661 in the Parish Chest.

## Appendix 15 – As The Church was Anciently.

Seating plan, taken from "The History of Myddle" by Richard Gough.

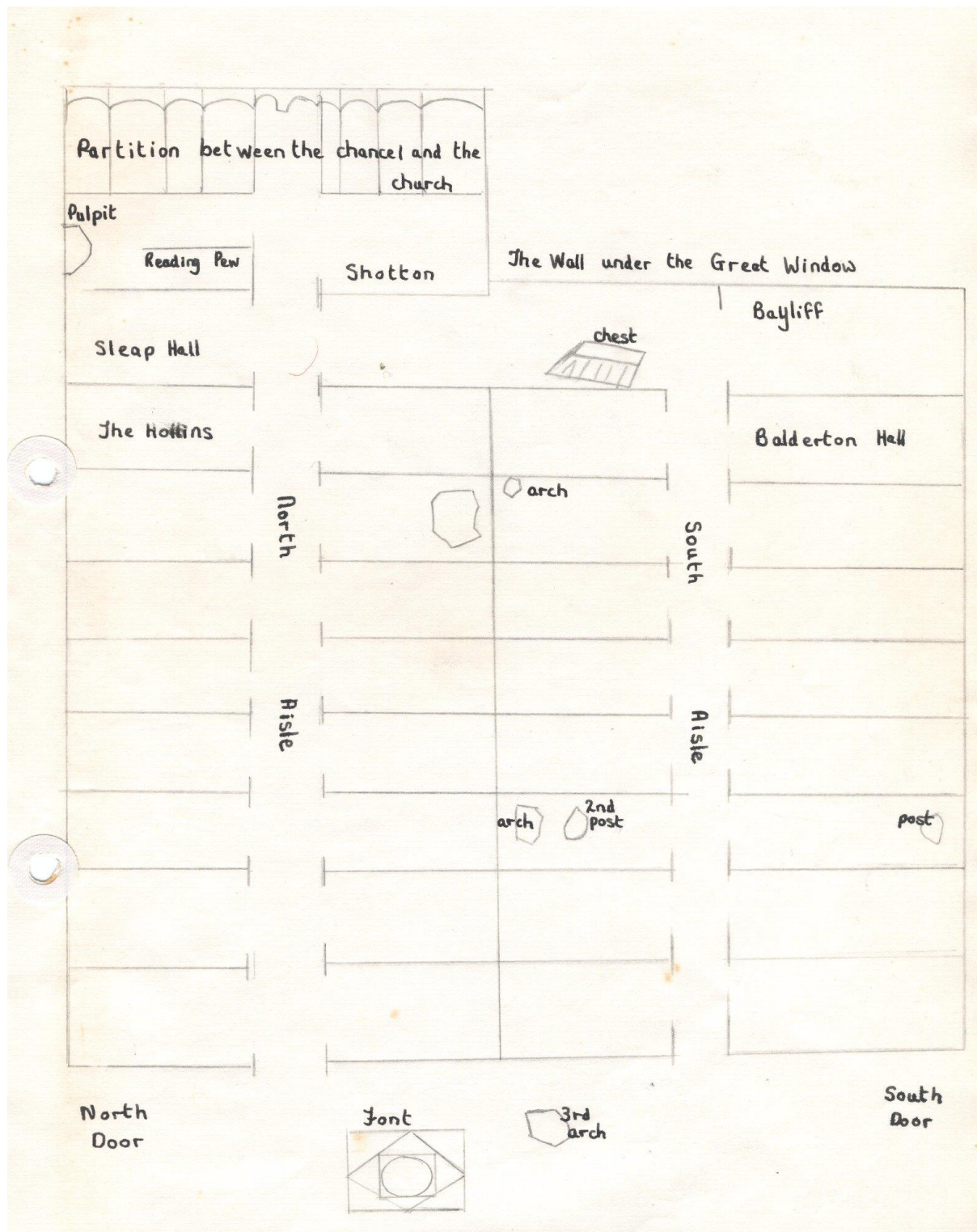

Seating plan, taken from “The History of Myddle” by Richard Gough.

[illegible]



## Appendix 17 – Seating Plan of 1744

Original in the Parish Chest

1	Mr Atcherley Marton Mr Hammer Sleep Hall					William Thordale for Mr - at Alderton
2	Joseph Cleaton (Duke's)					William Curston for his house
3	Joseph Cook Sleep Hall	1	Mr John Watkins For Shotton	Bartholomew Ebrey (Duke's)	1	Thomas Edge for Wright's tenement 3 - Sam Surnock Marton
4	Mr Atcherley Mr Hammer	2	John Bates	Tho Husbands (Duke's)	2	Thomas Shaw William Curston William Broughall
5	Mr Jeffries had been Mayd	3	A common seat	Tho Husbands (Duke's) Robert - of Hadnall one seat	3	Robert Davies Brandwood Ed Jones Brandwood John Marley, Robert Starway Bartholomew Mowd (Duke's)
6	W Crinston Balderton Hall Tho Womersley for Goulard	4	John Haynes - Marton William Curston - Balderton Joseph William - Newton Sam Richerton - Bilmersham	John Edge for Miss Price & Webscott	4	Will Broughall
	Pulpit	5	William Bucknell For Mr Watkins of Shotton	John Eaton William Eaton (Duke's) William Curston Balderton Sam Owen Alderton	5	Sam Davies (Duke's) Richard Moll (Duke's) John Watkins Middlewood Mr Atcherley for A. Davies
	Reading Desk	6	John Haynes - Marton Tho Shaw - Newton William Broughall	John Eaton 3 Thomas Price Thomas Wormalley 3 (Duke's)	6	Sam Givins for Mr Atcherley
		7	William Rogers Robert Davies - Hoston John Gier for Mr Jeffries	Mr R. Atcherley Alderton Tho Wynne Brandwood	7	Rich Groom (Duke's)
7	Mr Atcherley Marton	8	Adam Davies Bartholomew Moll (Duke's) Richard Mowd (Duke's)	Mr R Atcherley and J Wynne	8	John Ralphin Alderton (Duke's)
8	John Eaton William Eaton Thomas Price (Duke's)	9	William Broughall Ralph Guest (Duke's) R. Moll (Duke's)	Rob Davies, James Pugh (Duke's) Robert Starway John Marley	9	Mr Atcherley Marton Rogers Davies John Edwards John Barte
9	Tho Husbands (Duke's)	10	John Bates (Duke's) Will Curston Thomas Wormalley (Duke's)	Sam Surnock James Pugh (Duke's)	10	Rich Rogers Joseph Cleaton Joseph Tildley Thomas Price (Duke's)
10	John Edge for Miss Price & Webscott	11	Richard Moll for Brandwood (Duke's)	A Arthur Munsley John Hewitt (Duke's)	11	Mr Hammer for Ed Owen's house
11	Thomas Powis Eq. For Hardwig	12	James Watson widow Richard Owen (Duke's) (Duke's)	John Davis Robert Morris (Duke's)	12	Robt Groom
12	The Rector Mr. Leigh for Parsonage house	13	W. Atcherley for Freehold at Marton	Mr Hill for all his in Hadnall	13	George Birch. Hammer W. Curston Bilmersham - for Edgors tenement Marton
13	Mr Hammer Tho Shaw	14	Mr Genkes for the Birches	Richard Pigstock Hoston Joseph Tolbert Hoston John Hildinge Hoston	14	Sam Broughall for Mr Mayd
14	William Buddle - Webscott Tho Roberts - Webscott Tho Roberts - Hoston				15	John - at Hadnall
					16	Thomas Brown at Hadnall Rich Mayd - Hoston Will Eaton house at Goulard



## Appendix 18 – Seating plan of 1810

The Rector	The Rector		
1 Richard Atcherley Esq 3 Sleep Hall 3	1 Shotton	Lord Bridgewater 1	1 Alderton Mr Fox's Farm,
2 Lord Bridgewater			2 Balderton Hall
3 Sleep Hall	2 Lord Bridgewater	Lord Bridgewater 2	3 Lord Bridgewater
4 Richard Atcherley Esq	3 Richard Atcherley 1 Mr Fox Alderton 1 Mr Cureton Billmarsh 1	Lord Bridgewater 3	4 Samuel Stanforth
5 Lord Bridgewater	4 Lord Bridgewater	Webbscott 4	5 John Davies Newton
6 Balderton Hall	5 Shotton	Lord Bridgewater 5	6 Lord Bridge water
7 The Clerks Seat	6 Lord Bridgewater	Lord Bridge water 6	7 Rich Atcherley Esq
Pulpit and Desk	7 Mr Shingler Houlston 2 Mr Shingler Alderton 2	Mr Corbet Alderton 7	8 Richard Atcherley Esq
8 Richard Atcherley Esq	8 Mr Birch Lennemere Mr Powell Richard Atcherley	Lord Bridgewater 8	9 Lord Bridgewater
9 Lord Bridgewater	9 Mr Bickerton	Lord Bridgewater 9	10 Lord Bridgewater
10 Lord Bridgewater	* 10 Lord Bridgewater Mr Bickerton	Lord Bridgewater 10	11 Lord Bridgewater
11 Webbscott	11 Lord Bridgewater	Lord Bridgewater 11	12 Lord Bridgewater
12 John Hill Esq	12 Lord Bridgewater	Lord Bridge water 12	13 Lord Bridgewater
13 The Rector	13 Richard Atcherley Esq	Lord Berwick 13	* 14 John Bickerton Lord Bridgewater
14 Lord Bridgewater	14 Black Birches	Seth Pickstock Heston 14	15 George Hilditch Heston
			16 Mr Farmer and Mr Davies
			17 Lord Bridgewater.

"We whose names are hereunto subscribed being the owners and proprietors of Messuages or Dwellings Lands and Hereditanments in the Parish of Middle in the County of Salop do testify our full approbation of and consent to the above arrangements and exchange in pews and sitting in Church." 17<sup>th</sup> March 1810, Bridgewater, Richard Atcherley, Rich Bickerton, Sam Staneforth, Seth Pickstock.

\*These two pews were exchanged on 11<sup>th</sup> December 1820 by Robert Helerk Esq. And Richard Bickerton. Mr Bickerton giving N14 to and receiving N10 from Lord Bridgewater. Witness George Burd, Curate.

At the building of the Gallery the seat N1 belonging to Alderton Mr. Shingler's farm, late Mr. Fox farm was allowed by Mr Shingler to be taken for the staircase upon condition of receiving N14 in exchange

29<sup>th</sup> June 1829    George Burd, Curate



# Appendix 19 – Seating plan of 1855

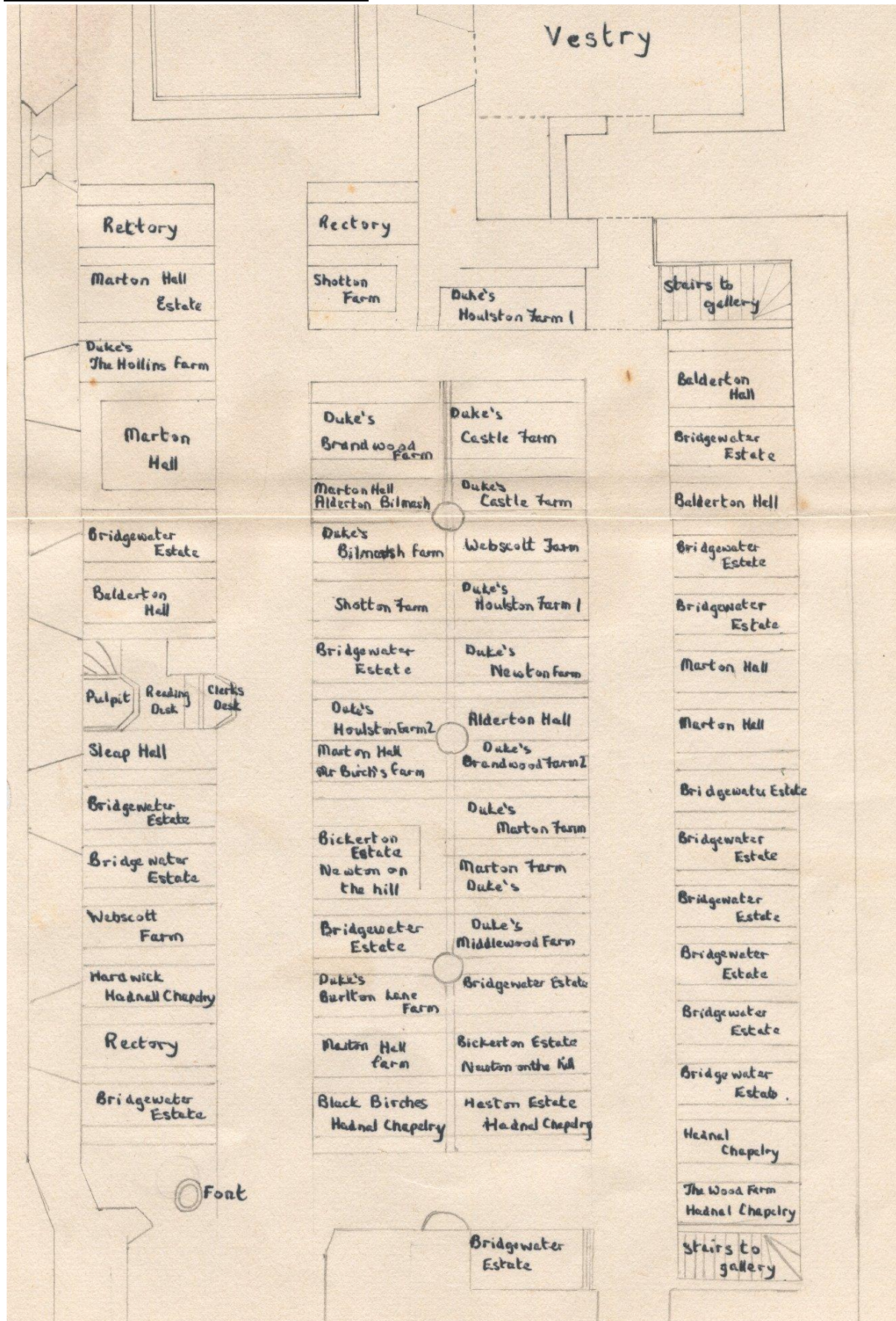



# Plan of the Gallery 1855

The Gallery  
1855

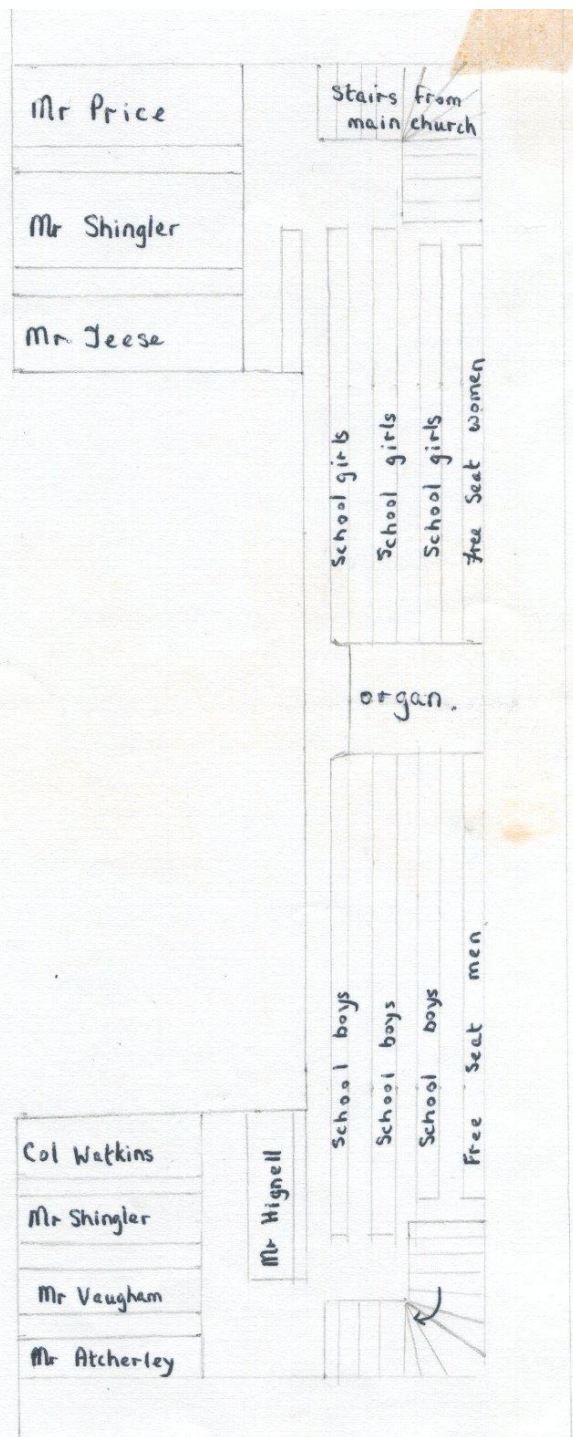



## Appendix 20 – Seating Plan 1858

